

MOBILE TILTING AND POSITIONING WORK TABLE - WT-2424

APPROX WEIGHT: 85.04 lbs.

DOES NOT INCLUDE WEIGHT OF POWER OR PACKAGING!!!

ANY ADDITIONS, DELETIONS, OR OMISSIONS MUST BE CORRECTED ON THIS DRAWING AS THIS DRAWING WILL BE CONSIDERED ALL INCLUSIVE

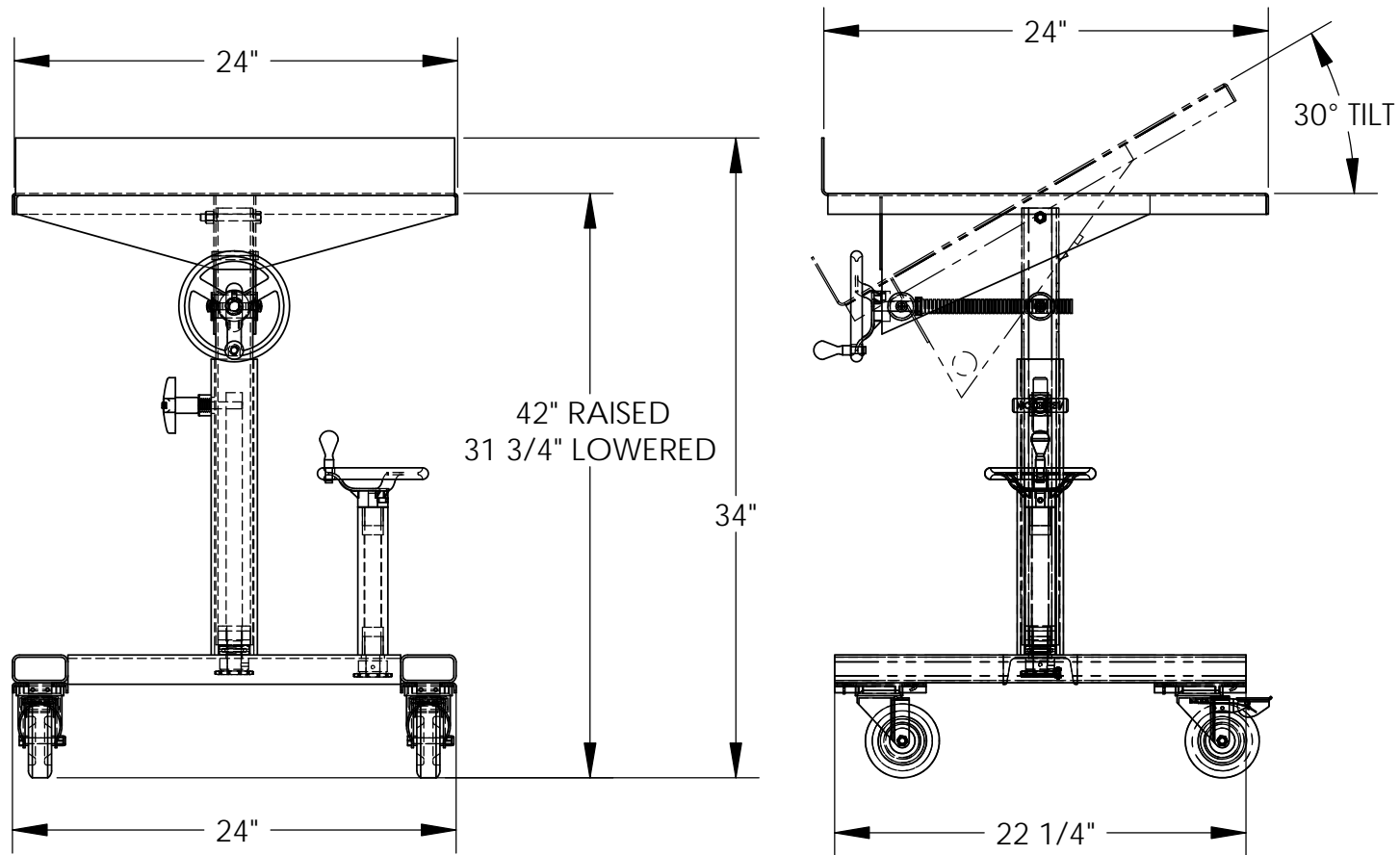

ANY ADDITIONS, DELETIONS, OR OMISSIONS MUST BE CORRECTED ON THIS DRAWING AS THIS DRAWING WILL BE CONSIDERED ALL INCLUSIVE

ALL GRAPHICS PROVIDED ARE FOR REFERENCE ONLY. IF CERTAIN DIMENSIONS ARE CRITICAL PLEASE VERIFY THOSE DIMENSIONS WITH YOUR SALESPERSON

STANDARD FEATURES

- MODEL NUMBER IS: WT-2424
- CAPACITY IS: 300 LBS
- OVERALL HEIGHT: 34"
- PLATFORM WIDTH IS: 24"
- PLATFORM LENGTH IS: 24"
- RAISED HEIGHT: 42"
- LOWERED HEIGHT: 31 3/4"
- BASE WIDTH: 24"
- BASE LENGTH: 22 1/4"
- 0 TO 30° TILT (CRANK WHEEL)
- TWO SWIVEL 4" X 1 1/4" POLYURETHANE DOUBLE-LOCKING CASTERS (FRONT)
- TWO SWIVEL 4" X 1 1/4" POLYURETHANE CASTERS (REAR)
- BASE IS PAINTED BLUE/ TOP IS POWDER COAT SILVER

DIMENSION TOLERANCE ± 1/4"

SPECIAL FEATURES

NONE

**SPECIAL UNITS ARE NON-RETURNABLE
*AVAILABLE AT ADDITIONAL COSTS

A P P R O V A L	I, THE UNDERSIGNED, AGREE THAT THE PRODUCT AS REPRESENTED SATISFIES DESIGN AND DIMENSION REQUIREMENTS. I ALSO ACKNOWLEDGE MY DUTY TO CONFIRM PRODUCT AND INSTALLATION COMPLIANCE WITH ALL APPLICABLE FEDERAL, STATE AND LOCAL REGULATIONS AND STANDARDS.	
	ALL SPECIAL UNITS ARE NON-RETURNABLE [] As drawn [] As marked	
Signed: _____		Date: _____
LEAD TIME WILL START UPON RECEIPT OF SIGNED APPROVAL DRAWING		

DISTRIBUTOR'S NAME:		P.O.#
VESTIL MANUFACTURING		X
DRAWN BY: M. BEIER		DATE: 01/16/08
REFERENCE: X		SALES: X
QUOTED LEAD TIME: X		SCALE: 1:10
QUOTE # X		FILE NAME: 16-007-021