



R5XEE-1006

"R" HEAVY-DUTY MODULAR CABINET

The heavy-duty cabinet, designed for intensive use, present the perfect fit to better respond to our customers needs. It is distinguished by the vast array of dimensions offered, accessories and its perfect modularity, but most of all by its durability.

The Rousseau cabinet comes in 6 different widths, each offered in different depths, for a total of 13 combinations, each available in 6 heights. Add to that the 10 drawer heights, and you have an incredible choice of possibilities. You're guaranteed to find the right size for your specific application.

Tested by an independent laboratory, the Rousseau cabinet proved to be the most durable on the market. The trials proved just how superior our drawer is. This allows us to be 100% confident in offering you a lifetime warranty on the drawer rolling mechanism.

The unique shape of the "R" drawer is a Rousseau Metal Inc. trademark and we own a design patent on the "R" drawer.

The Rousseau cabinet, in addition to being sturdy, offers a refined and unique look, which will stand the test of time. A shining example of unwavering durability.



The Rousseau drawer rolling mechanism is covered by a lifetime warranty.

Distributed by:
Custom Equipment Company
866-333-0728
sales@custommhs.com



Sturdy and distinct appearance that works in all sorts of different environments.

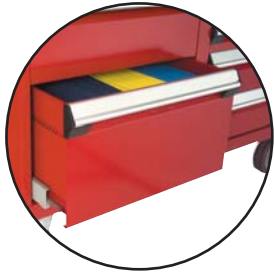

10 drawer heights and 7 drawer side heights are available.



True North American dimensions which allow for perfect modularity.



Housings with pre-determined fixing zones for installation of accessories : work surfaces, shelves, etc.



400 lb. capacity per drawer. The most heavy-duty in the industry.

General Dimensions

Available Heights

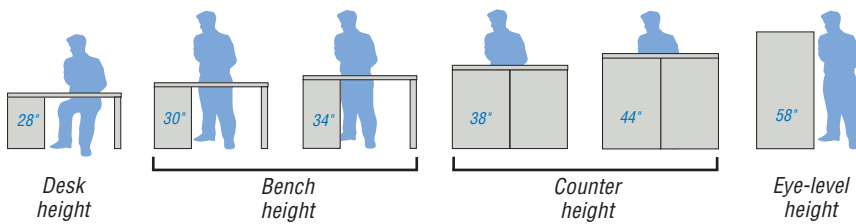

Width x Depth

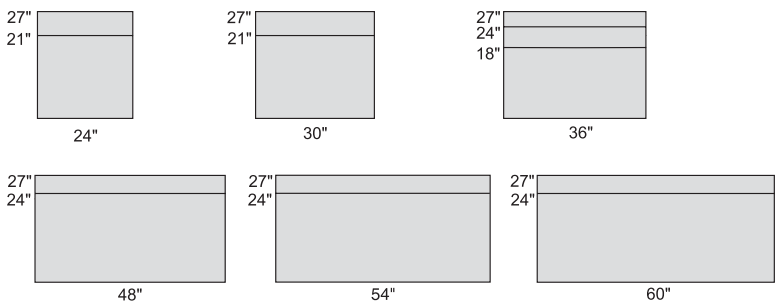

Index	Page(s)
"R" Heavy-Duty Modular Cabinet	4 - 5
Proposals	6 - 10
Accessories	11 - 19
Components	20 - 22
"L" Compact Cabinet	23
Proposals – Cabinets	24 - 25
Proposals – Drawer compartments	26 - 27
Accessories	28 - 31
Components	32 - 33

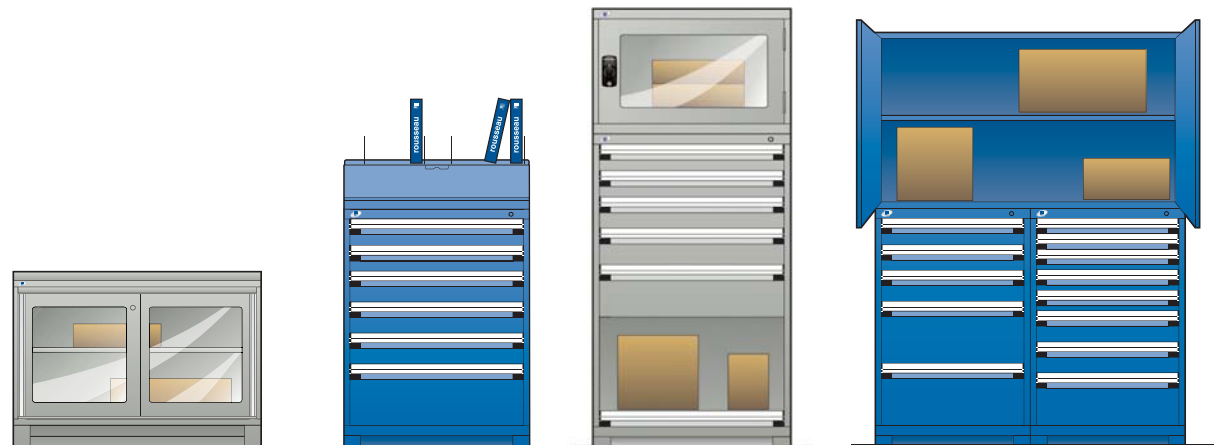

Shown here are several of the most popular heavy-duty modular cabinet models.

All proposals include a 2" front-access forklift base and a lock on the cabinet housing (for models with more than one drawer) or on the door.

Doors are factory installed with hinges on the right side. They may be installed on the left side, upon request.



IMPORTANT

Drawer partitions are included in models.

See number of compartments and proposed layouts on the following page.

NOTE

For drawers without partitioning, complete the even number following the last two digits of the model.

Ex.: R5ACD-2801 with R5ACD-2802 without

24" Wide



4 drawers
R5ACD-2801 24" x 21" x 30"
R5ACG-2801 24" x 27" x 30"



4 drawers
R5ACD-2813 24" x 21" x 30"
R5ACG-2813 24" x 27" x 30"



4 drawers
R5ACD-2805 24" x 21" x 30"
R5ACG-2805 24" x 27" x 30"



6 drawers
R5ACD-3001 24" x 21" x 32"
R5ACG-3001 24" x 27" x 32"



4 drawers
R5ACD-3005 24" x 21" x 32"
R5ACG-3005 24" x 27" x 32"



1 door/1 adjustable shelf/
1 bottom shelf
R5ACD-3009 24" x 21" x 32"
R5ACG-3009 24" x 27" x 32"



3 drawers
R5ACD-3405 24" x 21" x 36"
R5ACG-3405 24" x 27" x 36"



5 drawers
R5ACD-3403 24" x 21" x 36"
R5ACG-3403 24" x 27" x 36"



9 drawers
R5ACD-3805 24" x 21" x 40"
R5ACG-3805 24" x 27" x 40"



5 drawers
R5ACD-3807 24" x 21" x 40"
R5ACG-3807 24" x 27" x 40"

30" Wide



5 drawers
R5ADD-2801 30" x 21" x 30"
R5ADG-2801 30" x 27" x 30"



4 drawers
R5ADD-2803 30" x 21" x 30"
R5ADG-2803 30" x 27" x 30"



5 drawers
R5ADD-2805 30" x 21" x 30"
R5ADG-2805 30" x 27" x 30"



5 drawers
R5ADD-3003 30" x 21" x 32"
R5ADG-3003 30" x 27" x 32"



6 drawers
R5ADD-3007 30" x 21" x 32"
R5ADG-3007 30" x 27" x 32"



1 drawer/1 door/
1 bottom shelf
R5ADD-3009 30" x 21" x 32"
R5ADG-3009 30" x 27" x 32"



5 drawers
R5ADD-3815 30" x 21" x 40"
R5ADG-3815 30" x 27" x 40"



7 drawers
R5ADD-3803 30" x 21" x 40"
R5ADG-3803 30" x 27" x 40"



8 drawers
R5ADD-4401 30" x 21" x 46"
R5ADG-4401 30" x 27" x 46"



5 drawers
R5ADD-4411 30" x 21" x 46"
R5ADG-4411 30" x 27" x 46"



Drawer dimensions	Number of Compartments (layout code)					
	24" x 21"	24" x 27"	30" x 21"	30" x 27"	36" x 18"	36" x 24"
3" to 5"	12 (0308)	20 (0316)	24 (0518)	25 (0420)	24 (0518)	30 (0524)
6" to 8"	9 (0206)	12 (0209)	12 (0308)	12 (0308)	8 (0304)	12 (0308)
9" and higher	4 (0102)	6 (0104)	6 (0203)	9 (0206)	6 (0203)	9 (0206)

Drawer dimensions	Number of Compartments (layout code)					
	48" x 24"	48" x 27"	54" x 24"	54" x 27"	60" x 24"	60" x 27"
3" to 5"	40 (0732)	32 (0724)	40 (0930)	40 (0930)	70 (1356)	84 (1370)
6" to 8"	15 (0410)	15 (0410)	18 (0512)	18 (0512)	24 (0716)	21 (0614)
9" and higher	8 (0304)	8 (0304)	10 (0405)	10 (0405)	12 (0308)	12 (0308)

For inside drawer dimensions. **SEE PAGES 153-154**



9 drawers
 R5ADD-5805 30" x 21" x 60"
 R5ADG-5805 30" x 27" x 60"

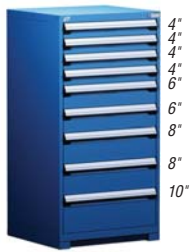

9 drawers
 R5ADD-5809 30" x 21" x 60"
 R5ADG-5809 30" x 27" x 60"



6 drawers
 R5ADD-5843 30" x 21" x 60"
 R5ADG-5843 30" x 27" x 60"



9 drawers
 R5ADD-5813 30" x 21" x 60"
 R5ADG-5813 30" x 27" x 60"



1 door/1 bottom shelf/5 drawers
 R5ADD-5845 30" x 21" x 60"
 R5ADG-5845 30" x 27" x 60"

36" Wide



4 drawers
 R5AEC-2801 36" x 18" x 30"
 R5AEE-2801 36" x 24" x 30"



4 drawers
 R5AEC-2803 36" x 18" x 30"
 R5AEE-2803 36" x 24" x 30"



5 drawers
 R5AEC-3005 36" x 18" x 32"
 R5AEE-3005 36" x 24" x 32"



2 drawers
 R5AEC-3021 36" x 18" x 32"
 R5AEE-3021 36" x 24" x 32"



5 drawers
 R5AEC-3805 36" x 18" x 40"
 R5AEE-3805 36" x 24" x 40"



5 drawers
 R5AEC-3807 36" x 18" x 40"
 R5AEE-3807 36" x 24" x 40"



7 drawers
 R5AEC-4403 36" x 18" x 46"
 R5AEE-4403 36" x 24" x 46"



11 drawers
 R5AEC-4405 36" x 18" x 46"
 R5AEE-4405 36" x 24" x 46"



Double door/ 1 adjustable shelf / 1 bottom shelf
 R5AEC-4412 36" x 18" x 46"
 R5AEE-4412 36" x 24" x 46"



8 drawers
 R5AEC-4415 36" x 18" x 46"
 R5AEE-4415 36" x 24" x 46"



11 drawers
 R5AEC-5803 36" x 18" x 60"
 R5AEE-5803 36" x 24" x 60"



9 drawers
 R5AEC-5813 36" x 18" x 60"
 R5AEE-5813 36" x 24" x 60"

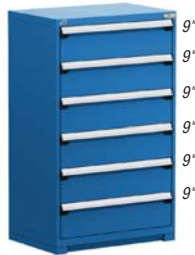

6 drawers
 R5AEC-5859 36" x 18" x 60"
 R5AEE-5859 36" x 24" x 60"



8 drawers
 R5AEC-5825 36" x 18" x 60"
 R5AEE-5825 36" x 24" x 60"



7 drawers
 R5AEC-5861 36" x 18" x 60"
 R5AEE-5861 36" x 24" x 60"

48" Wide



5 drawers
 R5AHE-3003 48" x 24" x 32"
 R5AHG-3003 48" x 27" x 32"



7 drawers
 R5AHE-3801 48" x 24" x 40"
 R5AHG-3801 48" x 27" x 40"



1 sliding door/1 adjustable shelf/
 1 bottom shelf
 R5AHE-3803 48" x 24" x 40"
 R5AHG-3803 48" x 27" x 40"



5 drawers
 R5AHE-3807 48" x 24" x 40"
 R5AHG-3807 48" x 27" x 40"



9 drawers
 R5AHE-4405 48" x 24" x 46"
 R5AHG-4405 48" x 27" x 46"



7 drawers
 R5AHE-4407 48" x 24" x 46"
 R5AHG-4407 48" x 27" x 46"



Double door/ 1 adjustable shelf /
 1 bottom shelf
 R5AHE-4414 48" x 24" x 46"
 R5AHG-4414 48" x 27" x 46"



5 drawers
 R5AHE-4427 48" x 24" x 46"
 R5AHG-4427 48" x 27" x 46"



15 drawers
 R5AHE-5805 48" x 24" x 60"
 R5AHG-5805 48" x 27" x 60"



6 drawers
 R5AHE-5807 48" x 24" x 60"
 R5AHG-5807 48" x 27" x 60"



8 drawers
 R5AHE-5809 48" x 24" x 60"
 R5AHG-5809 48" x 27" x 60"



9 drawers
 R5AHE-5813 48" x 24" x 60"
 R5AHG-5813 48" x 27" x 60"

54" Wide



6 drawers

R5AJE-3401	54" x 24" x 36"
R5AJG-3401	54" x 27" x 36"



7 drawers

R5AJE-3403	54" x 24" x 36"
R5AJG-3403	54" x 27" x 36"



5 drawers

R5AJE-3801	54" x 24" x 40"
R5AJG-3801	54" x 27" x 40"



6 drawers

R5AJE-3803	54" x 24" x 40"
R5AJG-3803	54" x 27" x 40"



5 drawers/1 roll-out shelf

R5AJE-4401	54" x 24" x 46"
R5AJG-4401	54" x 27" x 46"



5 drawers

R5AJE-4405	54" x 24" x 46"
R5AJG-4405	54" x 27" x 46"



7 drawers

R5AJE-4403	54" x 24" x 46"
R5AJG-4403	54" x 27" x 46"



Double door/ 3 adjustable shelves/
1 bottom shelf

R5AJE-5802	54" x 24" x 60"
R5AJG-5802	54" x 27" x 60"



8 drawers

R5AJE-5803	54" x 24" x 60"
R5AJG-5803	54" x 27" x 60"



60" Wide



5 drawers

R5AKE-3805	60" x 24" x 40"
R5AKG-3805	60" x 27" x 40"



7 drawers

R5AKE-3807	60" x 24" x 40"
R5AKG-3807	60" x 27" x 40"



6 drawers

R5AKE-4401	60" x 24" x 46"
R5AKG-4401	60" x 27" x 46"



1 sliding door/2 adjustable shelves/
1 bottom shelf

R5AKE-4406	60" x 24" x 46"
R5AKG-4406	60" x 27" x 46"



5 drawers/1 roll-out shelf

R5AKE-5801	60" x 24" x 60"
R5AKG-5801	60" x 27" x 60"



9 drawers

R5AKE-5803	60" x 24" x 60"
R5AKG-5803	60" x 27" x 60"



Security Accessories and Recommendations

Vertical Security Bar

RB10



Locks all of the cabinet drawers with one padlock;
Safety hasp is located at the top of the bar to facilitate access;
Available to cover overall drawer heights from 24" to 54";
Complete access to drawers is possible, even when installed against a wall;
Possible to install more than one bar on the same cabinet (for different users);
Installs on the right side.

Product #	Height
RB10-24LPA	24"
RB10-26LPA	26"
RB10-30LPA	30"
RB10-34LPA	34"
RB10-40LPA	40"
RB10-54LPA	54"

Security Panel

RF91

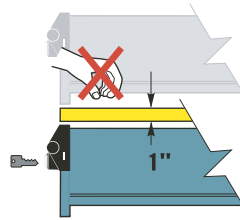

Blocks access between two drawers with locks;
Usable space in cabinet reduced by 1";
Installed between two drawers;
Allows for the cabinet to be divided up for more than one user;
Order by specifying the width and dept.
Ex.: RF91-36 24 for a 36" W x 24" D security panel.

Product #
RF91-_____

Cabinet Lock



Allows user to lock all drawers and roll-out shelves in the cabinet at same time;
Possible to change drawer and roll-out shelf positions;
Easy to retrofit;
Order by adding L3 to the cabinet housing number. Ex.: RA30-302758L3;
For replacement parts or to retrofit this mechanism, order RB00-DDHHL3.

Product #
L3



True One-Drawer-at-a-Time System



RB15

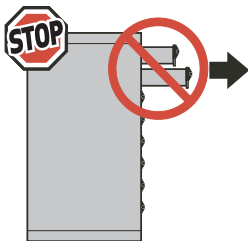

Prevents multiple drawers from opening at the same time, which ensures the cabinet's stability and users' safety;
Order by adding "A" to the cabinet number.
Ex.: RA30-302758A;
SEE PAGE 20

To retrofit this mechanism, order a RB15 and specify the number of drawers and roll-out shelves in the cabinet, Ex.: RB15-58-07 for a cabinet with 7 drawers;
One kit per cabinet.

Product #	Cabinet Height
RB15-28-___	28"
RB15-30-___	30"
RB15-34-___	34"
RB15-38-___	38"
RB15-44-___	44"
RB15-58-___	58"



Recommended for mobile cabinets and cabinets not anchored to the floor.

Cabinet Safety Hasp



Allows user to lock all drawers and roll-out shelves in the cabinet at the same time;
Possible to change drawer and roll-out shelf positions;
Alternative to the RB10 vertical security bar;
Easy to retrofit;
Order by adding LP to the cabinet housing number. Ex.: RA30-302738LP;
For replacement parts or to retrofit this mechanism, order RB00-DDHHL3.

Product #
LP

Electronic Lock System



L50



Allows user to electronically lock all drawers in the cabinet at the same time;
No key required;
Up to 20 different users can be programmed;
4-8 digit access codes;
Simplifies managing access to drawers;
To order the complete mechanism with a drawer cabinet, order a RB00-DDHHL50;
To order as a replacement lock, order a HA62-L50.
SEE PAGE 211

Product #
L50



R5AEE-3023

Cabinet Tops

Steel Top with Rubber Mat

RC32



Non-slip rubber surface;
Sides and back formed with a double fold : 1" high.

Laminated Hardwood Top

WS14



Top for general industrial applications;
Thickness : 1 3/4";
Made with varnished hardwood slats;
90° radius front edge for more comfort;
Good impact resistance;
Attractive appearance.

Stainless Steel Top

RC35



16 GA stainless steel : RC35-WWDD;
12 GA stainless steel : RC35-WWDD-12;
Serves as a work surface and protects the cabinet against impacts;
Particle board top with stainless steel cover (brushed finish #4);
Excellent corrosion and chemical resistance;
The top respects the CARB regulations on formaldehyde emissions;
Welded corners for attractive look;
Thickness : 1 3/4";
To order a top in 12 GA, complete the product number with 12.

Marine Edge Stainless Steel Top

RC35



Marine edge 16 GA stainless steel : RC35-WWDD-16M;
Marine edge 12 GA stainless steel : RC35-WWDD-12M;
Prevents small objects or liquids from falling or spilling from the work surface;
Serves as a work surface and protects cabinet against impacts;
Composite wood top with stainless steel cover (brushed finish #4);
Excellent corrosion and chemical resistance;
The top respects the CARB regulations on formaldehyde emissions;
Welded corners for attractive look;
Thickness : 1 3/4";
Order by specified the steel gauge.
Ex. : RC35-WWDD-16M for a marine edge 16 GA stainless steel top.

Painted Steel Top

RC37



Serves as a work surface and protects cabinet against impacts;
Composite wood top with painted steel cover;
The top respects the CARB regulations on formaldehyde emissions;
Welded corners for attractive look;
Thickness : 1 3/4".

Galvanized Steel Top

RC36



Serves as a work surface and protects the cabinet against impacts;
Composite wood top with galvanized cover;
The top respects the CARB regulations on formaldehyde emissions;
Thickness : 1 3/4".

Dimensions		Type of top					
W	D	Steel Top with Rubber Mat	Laminated Hardwood Top	Stainless Steel Top	Marine Edge Stainless Steel Top	Galvanized Steel Top	Painted Steel Top
24"	21"	RC32-2421-01					
	27"	RC32-2427-01					
	21"	RC32-3021-01					
30"	24"	RC32-3024-01					
	27"	RC32-3027-01	WS14-3027A*	RC35-3027-__**	RC35-3027-__M*	RC36-3027	RC37-3027
	30"	RC32-3030-01	WS14-3030A*	RC35-3030-__**	RC35-3030-__M*	RC36-3030	RC37-3030
36"	18"	RC32-3618-01	WS14-3618A*				RC37-3618
	21"	RC32-3621-01	WS14-3621A*				RC37-3621
	24"	RC32-3624-01	WS14-3624A	RC35-3624-__**	RC35-3624-__M*	RC36-3624	RC37-3624
	27"	RC32-3627-01	WS14-3627A*	RC35-3627-__**	RC35-3627-__M*	RC36-3627	RC37-3627
	30"	RC32-3630-01	WS14-3630A*	RC35-3630-__**	RC35-3630-__M*	RC36-3630	RC37-3630
48"	24"	RC32-4824-01	WS14-4824A*	RC35-4824-__**	RC35-4824-__M*	RC36-4824	RC37-4824
	27"	RC32-4827-01	WS14-4827A	RC35-4827-__**	RC35-4827-__M*	RC36-4827	RC37-4827
	30"	RC32-4830-01	WS14-4830A*	RC35-4830-__**	RC35-4830-__M*	RC36-4830	RC37-4830
54"	24"	RC32-5424-01	WS14-5424A*	RC35-5424-__**	RC35-5424-__M*	RC36-5424	RC37-5424
	27"	RC32-5427-01	WS14-5427A*	RC35-5427-__**	RC35-5427-__M*	RC36-5427	RC37-5427
	30"	RC32-5430-01	WS14-5430A*	RC35-5430-__**	RC35-5430-__M*	RC36-5430	RC37-5430
60"	24"	RC32-6024-01	WS14-6024A*	RC35-6024-__**	RC35-6024-__M*	RC36-6024	RC37-6024
	27"	RC32-6027-01	WS14-6027A*	RC35-6027-__**	RC35-6027-__M*	RC36-6027	RC37-6027
	30"	RC32-6030-01	WS14-6030A	RC35-6030-__**	RC35-6030-__M*	RC36-6030	RC37-6030
72"	24"	RC32-7224-01	WS14-7224A	RC35-7224-__**	RC35-7224-__M*	RC36-7224	RC37-7224
	27"	RC32-7227-01	WS14-7227A*	RC35-7227-__**	RC35-7227-__M*	RC36-7227	RC37-7227
	30"	RC32-7230-01	WS14-7230A	RC35-7230-__**	RC35-7230-__M*	RC36-7230	RC37-7230

NOTE * Please check with your customer service representative for lead time. ** 12 GA only.

NOTE For compatibility with doors with frame, choose top that is 3" deeper than your cabinet.
Ex.: 27" D cabinet + door with 3" frame = 30" D top.

Slope Top

RC30

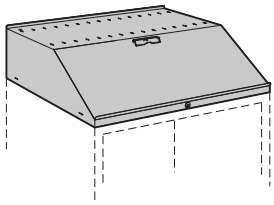

The 30° inclined surface opens to store documents or other items;
Adapted to install a lamp with a 1/2" diameter pivot rod;
Capacity : 100 lb. (evenly distributed);
For compatibility with doors with frame, choose a top that is 3" deeper than your cabinet.
Ex.: 27" D cabinet + door with 3" frame = 30" D slope top;
Standard lock included.

SEE PAGE 139

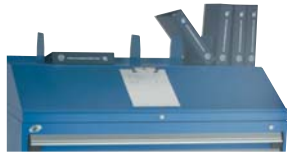

Product #	W x D x H	Compatible Divider
RC30-242708L3	24" x 27" x 8"	SH52-1506
RC30-302708L3	30" x 27" x 8"	SH52-1506
RC30-303008L3	30" x 30" x 8"	SH52-1806
RC30-362408L3	36" x 24" x 8"	SH52-1206
RC30-362708L3	36" x 27" x 8"	SH52-1506
RC30-363008L3	36" x 30" x 8"	SH52-1806
RC30-482408L3	48" x 24" x 8"	SH52-1206
RC30-482708L3	48" x 27" x 8"	SH52-1506
RC30-483008L3	48" x 30" x 8"	SH52-1806

Partial Divider

PATENTED

SH52

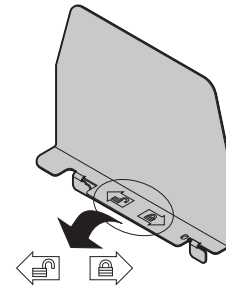

Pictograms to facilitate installation

Innovative patented divider, facilitates easy position changes;
Height : 5 1/2";
Easy installation, without tools.

Product #	Divider Depth	For RC30
SH52-1206	7 1/8"	24" deep
SH52-1506	10 1/8"	27" deep
SH52-1806	13 1/8"	30" deep

Back and Side Stop

NEW DIMENSION

WS18/WS98



Painted steel : WS18;
Stainless steel : WS98;
Can be installed on back or sides according to top dimensions;
Can be installed on WS14, RC35, RC36, and RC37 tops;
Height : 5". Clears top by approx. 3 1/4";
To order, complete the part # with steel choice needed.

Product #	Length
WS_-2405	24"
WS_-2705	27"
WS_-3005	30"
WS_-3605	36"
WS_-4205	42"
WS_-4805	48"
WS_-5405	54"
WS_-6005	60"
WS_-7205	72"



Power Feed Panel/Cover Panel

Power Feed Panel

RC64/RC65



Painted steel : RC64;
Stainless steel : RC65;
Includes a power bar with 3 12A outlets for 15A circuit;
2 options available : 2 USB ports and/or perforations for air connection and a perforation (covered with a finishing panel) for installation of a telephone jack or computer network;
Can be installed on RC35 and RC37 tops;
Chose desired width when ordering between 30", 36", 48", 54", 60", 72".
Ex.: RC64-301001 for a 30" wide panel;
Indicate with or without a back panel when ordering
Without : 01 With : 02
Ex.: RC64-301001 without back panel.



Air connection



USB ports



For Phone/network

Product #	Option
RC64-__10__	-
RC64-__11__	Perforations
RC64-__12__	2 USB ports
RC64-__13__	2 USB ports, perforations
RC65-__10__	-
RC65-__11__	Perforations
RC65-__12__	2 USB ports
RC65-__13__	2 USB ports, perforations

Cover Panel

RC66/RC67



Painted steel : RC66;
Stainless steel : RC67;
Can be combined with a power feed panel on the same workstation or cabinet;
Available with or without back finishing panel;
Can be installed on RC35 and RC37 tops;
Indicate type of finish when ordering.
Ex.: RC66-3001 for painted steel.

Product #	Width	With or Without Back Panel
RC__-2401	24"	Without back panel
RC__-2402	24"	With back panel
RC__-3001	30"	Without back panel
RC__-3002	30"	With back panel
RC__-3601	36"	Without back panel
RC__-3602	36"	With back panel
RC__-4801	48"	Without back panel
RC__-4802	48"	With back panel
RC__-5401	54"	Without back panel
RC__-5402	54"	With back panel
RC__-6001	60"	Without back panel
RC__-6002	60"	With back panel
RC__-7201	72"	Without back panel
RC__-7202	72"	With back panel

Finishing Panel for Computer Support

RC68/RC69

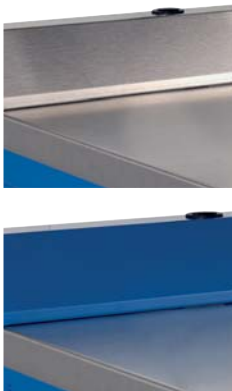

Painted steel : RC68;
Stainless steel : RC69;
Can be installed with a power feed panel or a cover panel;
Order by indicating the type of finish.
Ex.: RC68-2401 for painted steel;
Available with or without back finishing panel;
Equipped with a perforation on the center for installation of RC59 computer supports.

Product #	Width	With or Without Back Panel
RC__-2401	24"	Without back panel
RC__-2402	24"	With back panel



R5XHG-1016

Computer Supports

All models presented includes these specifications :

Installs on the work surface with the RC68 or RC69 finishing panel for computer support;

Compatible with the following work surface : WS14, RC35, RC36 and RC37;

Each support comes with an 18" high post allowing a custom fit for each user;

The work surface shall extend beyond the rear by 1 1/2";

Articulating arms, adaptors and trays are painted in black;

Does not install directly on the housing.

LCD Monitor Support



Designed to support most LCD monitors up to 21" available on the market;
Includes one or two double articulating arms;
Positioning of monitor anchors comply with VESA 75 and 100 standards;
The double articulating arm allows for increased adjustability;
The screen can also be tilted for better ergonomics;
Single or double LCD monitor support available for order.

Product #	For
RC59-03	Single screen
RC59-04	Double screen

Laptop Support



Designed to hold a laptop computer, papers, binders or any other object;
Usable tray surface : 14" W x 12" D;
Includes one double articulating arm and the tray;
The double articulating arm allows for increased adjustability;
The tray can also be tilted for better ergonomics.

Product #
RC59-42

LCD Monitor, Keyboard and Mouse Support



Designed to hold a computer monitor, keyboard and mouse;
Usable surface of the keyboard and mouse tray: 23 5/8" W x 8 1/2" D;
Includes one articulating arm and the tray;
Positioning of monitor anchors comply with VESA 75 and 100 standards;
Can support most LCD monitors up to 21" available on the market;
Tray and screen can also be tilted for better ergonomics.

Product #
RC59-21

Electronic Tablet Support



Designed to support most electronic tablets on the market;
Includes one double articulating arm and the tablet support;
Safely holds the tablet in place;
The holding clamps and back of the support are rubberized to help prevent scratches and damage to the device;
The double articulating arm allows for increased adjustability;
The support can also be tilted for better ergonomics;
Electronic tablet size compatible with support:
– height: 6" to 7 1/2"
– width: 9" to 12".

Product #
RC59-62

ESD Protection

ESD Cabinet

RC50



Allows for the safe storage of electronic components;
Special paint dissipates electric charges;
Grounding cord and ground wrist strap socket are included. Cord resistance is 1 M Ω;
To order a cabinet with ESD protection, please order a RC50-01 grounding kit and specify dissipative paint color Black 090.

Product #
RC50-01

NOTE * Contact customer service for ESD paint prices

Grounding Wrist Strap

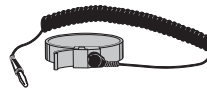

Made of stretch material;
Comes with a 6" cord with 1M Ω resistance;
Dissipates electric charges that may damage electronic components.

Product #
70000320

Conductive Plastic Bins



SEE PAGE 176

Dissipative Top



SEE PAGE 113

Bases

Front Access Forklift Base

RA52

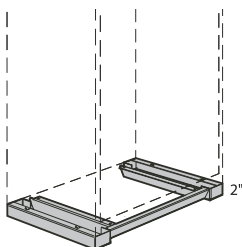

2" high base designed for moving the cabinet from the front with a forklift;

Front cover plate included;

Includes a recessed kick-plate in the center of the cabinet to allow user to stand closer to cabinet;

Designed to enable user to anchor cabinet to the floor;

Compatible with RA74 leveling glides;

Compatible with the RA54 rear base cover plate, offered as an option;

Note : Not compatible with casters;

Note : Not designed for stacking applications.

Front and Side Access Forklift Base

RA53

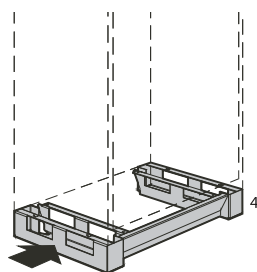

4" high base designed for moving the cabinet from the front or side with a forklift, or from the front with a pallet-jack;

Front cover plate included;

Includes a recessed kick-plate in the center of the cabinet to allow user to stand closer to cabinet;

Designed to enable user to anchor cabinet to the floor;

Compatible with RA74 leveling glides;

Compatible with the RA54 rear base cover plate, offered as an option;

Note : Not compatible with casters;

Note : Not designed for stacking applications.

Product #	W x H
RA52-242102	24" x 21"
RA52-242702	24" x 27"
RA52-302102	30" x 21"
RA52-302702	30" x 27"
RA52-361802	36" x 18"
RA52-362402	36" x 24"
RA52-362702	36" x 27"

Product #	W x H
RA52-482402	48" x 24"
RA52-482702	48" x 27"
RA52-542402	54" x 24"
RA52-542702	54" x 27"
RA52-602402	60" x 24"
RA52-602702	60" x 27"

Product #	W x H
RA53-242104	24" x 21"
RA53-242704	24" x 27"
RA53-302104	30" x 21"
RA53-302704	30" x 27"
RA53-361804	36" x 18"
RA53-362404	36" x 24"
RA53-362704	36" x 27"

Product #	W x H
RA53-482404	48" x 24"
RA53-482704	48" x 27"
RA53-542404	54" x 24"
RA53-542704	54" x 27"
RA53-602404	60" x 24"
RA53-602704	60" x 27"

Leveling Glide Kit

RA74

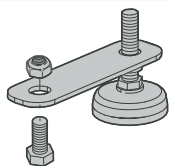

Sold in kits of 4;

Serves to adjust the height of cabinet housings 1 1/8" to 2" on uneven floor surfaces.

Product #

RA74-01

Angled Cover Plate

RA54

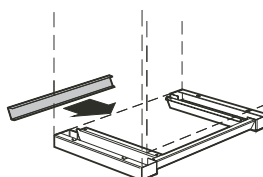

Closes off the back of 2" and 4" forklift bases (RA52 and RA53).

Product #	W x H
RA54-2402	24" x 2"
RA54-2404	24" x 4"
RA54-3002	30" x 2"
RA54-3004	30" x 4"
RA54-3602	36" x 2"
RA54-3604	36" x 4"
RA54-4802	48" x 2"
RA54-4804	48" x 4"
RA54-5402	54" x 2"
RA54-5404	54" x 4"
RA54-6002	60" x 2"
RA54-6004	60" x 4"

Recessed Base

RA55/RA57

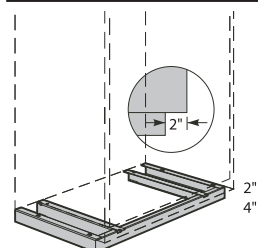

Painted steel : RA55;

Stainless steel : RA57;

Designed to raise the height of a cabinet by 2" or 4";

Includes a removable cover plate at the front for aesthetics;

Front cover plate is on a straight angle to facilitate cleaning floors;

2" recessed space to allow user to stand closer to cabinet;

Designed to allow user to anchor the cabinet to the floor;

Compatible with RA74 leveling glides;

Compatible with the RA56/RA58 rear base cover plate, offered as an option;

Note : Not compatible with casters;

Note : Not designed for stacking applications;

Order by indicating the type of steel finish. Ex.: RA57-302702 for a stainless steel base 30" W x 27" D x 2" H.

Product #	W x D x H
RA_-242102	24" x 21" x 2"
RA_-242104	24" x 21" x 4"
RA_-242702	24" x 27" x 2"
RA_-242704	24" x 27" x 4"
RA_-302102	30" x 21" x 2"
RA_-302104	30" x 21" x 4"
RA_-302702	30" x 27" x 2"
RA_-302704	30" x 27" x 4"
RA_-361802	36" x 18" x 2"
RA_-361804	36" x 18" x 4"
RA_-362402	36" x 24" x 2"
RA_-362404	36" x 24" x 4"
RA_-362702	36" x 27" x 2"
RA_-362704	36" x 27" x 4"

Product #	W x D x H
RA_-482402	48" x 24" x 2"
RA_-482404	48" x 24" x 4"
RA_-482702	48" x 27" x 2"
RA_-482704	48" x 27" x 4"
RA_-542402	54" x 24" x 2"
RA_-542404	54" x 24" x 4"
RA_-542702	54" x 27" x 2"
RA_-542704	54" x 27" x 4"
RA_-602402	60" x 24" x 2"
RA_-602404	60" x 24" x 4"
RA_-602702	60" x 27" x 2"
RA_-602704	60" x 27" x 4"

Straight Cover Plate

RA56/RA58

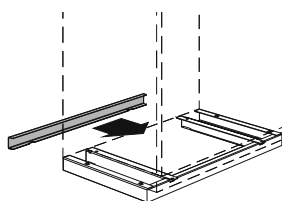

Painted steel : RA56;

Stainless steel : RA58;

Closes off the back of 2" and 4" recessed bases (RA55 or RA57);

Order by indicating the type of steel finish. Ex.: RA58-4804 for a straight cover plate in stainless steel 48" W x 4" H.

Product #	W x H
RA_-2402	24" x 2"
RA_-2404	24" x 4"
RA_-3002	30" x 2"
RA_-3004	30" x 4"
RA_-3602	36" x 2"
RA_-3604	36" x 4"
RA_-4802	48" x 2"
RA_-4804	48" x 4"
RA_-5402	54" x 2"
RA_-5404	54" x 4"
RA_-6002	60" x 2"
RA_-6004	60" x 4"

Drawers, Roll-out Shelves and Locking or Security Mechanisms

Heavy-Duty Modular Drawer

RF31 / RF35

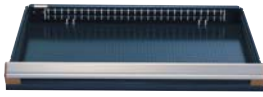

Drawer in painted steel : RF31;
 Drawer with stainless steel drawer front : RF35;
 400 lb. capacity, 100% extension;
 Heavy-duty construction;
 Easy to install;
 Vast choice of accessories offered to adapt to your storage needs;

SEE PAGES 173-177

Available drawer heights :
 3", 4", 5", 6", 7", 8", 9", 10", 12" and 14";

Order by adding the drawer height to the part # and by specifying the type of drawer front (painted steel or stainless steel).
 Ex.: RF31-362406;

For modular drawers with layouts.

SEE PAGES 156-172

Product #	W x D	Product #	W x D
RF_-2421	24" x 21"	RF_-4824	48" x 24"
RF_-2427	24" x 27"	RF_-4827	48" x 27"
RF_-3021	30" x 21"	RF_-5424	54" x 24"
RF_-3027	30" x 27"	RF_-5427	54" x 27"
RF_-3618	36" x 18"	RF_-6024	60" x 24"
RF_-3624	36" x 24"	RF_-6027	60" x 27"
RF_-3627	36" x 27"		

Heavy-Duty 3-Sided Access Roll-Out Shelf

RF44



400 lb. capacity, 100% extension;
 Heavy-duty construction;
 Easy to install;
 Galvanized steel with 1 1/2" edge on back;
 Height : 5";
 May serve as work surface.

Product #	W x D	Product #	W x D
RF44-2421	24" x 21"	RF44-4824	48" x 24"
RF44-2427	24" x 27"	RF44-4827	48" x 27"
RF44-3021	30" x 21"	RF44-5424	54" x 24"
RF44-3027	30" x 27"	RF44-5427	54" x 27"
RF44-3618	36" x 18"	RF44-6024	60" x 24"
RF44-3624	36" x 24"	RF44-6027	60" x 27"
RF44-3627	36" x 27"		

Drawer Lock

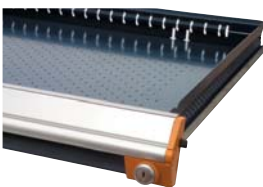

Compatible with all drawer dimensions;
 Does not affect usable drawer space;
 Easy to retrofit;
 Order by adding L3 to drawer or partitioning model number. Ex.: RF31-362406L3;
 For replacement parts or to retrofit this mechanism, order RY01-L3.

Product #
 L3



Heavy-Duty Front Access Roll-Out Shelf

RF40



400 lb. capacity, 100% extension;
 Heavy-duty construction;
 Easy to install;
 Painted steel with 3" edges on sides and back;
 Height : 6";
 Full access to contents.

Product #	W x D	Product #	W x D
RF40-2421	24" x 21"	RF40-4824	48" x 24"
RF40-2427	24" x 27"	RF40-4827	48" x 27"
RF40-3021	30" x 21"	RF40-5424	54" x 24"
RF40-3027	30" x 27"	RF40-5427	54" x 27"
RF40-3618	36" x 18"	RF40-6024	60" x 24"
RF40-3624	36" x 24"	RF40-6027	60" x 27"
RF40-3627	36" x 27"		

Integrated Lock-In Mechanism



Activated by tilting the handle up;
 Allows user to open the drawer and the roll-out shelf with one hand only;
 Close by simply pushing it;
 Stops drawer and roll-out shelf from opening on their own;
 Easy to retrofit;
 Order by adding A to the drawer or partitioning, or roll-out shelf model number.
 Ex.: RF31-362406A;

For replacement parts or to retrofit this mechanism, order RY08-WWA.

Product #
 A

Econo Lock-In Mechanism



Activated with the right hand by sliding the mechanism with thumb;
 Drawer and roll-out shelf close without having to reactivate the slide mechanism;
 Stops drawer and roll-out shelf from opening on their own;
 Easy to retrofit;
 Order by adding B to the drawer or partitioning, or roll-out shelf model number.
 Ex.: RF31-362406B;

For replacement parts or to retrofit this mechanism, order RY01-B.

Product #
 B

Lock-Out Mechanism

RF85



For both drawers and roll-out shelves;
 Locks drawers and roll-out shelves in open position;
 Activated manually, only when required;
 Compatible with all accessories drawer;
 Plastic bins positioned in the back row, may make it more difficult to activate mechanism.

Product #
 RF85